



Nauta

SHIPREPAIR YARD
1926-2012

Location

- NAUTA Shiprepair Yard is located in Gdynia, in the northern part of Poland, on the industrial area next to the harbor of Gdynia;
- It occupies the area of about 19.7 hectares;
- It is well communicated with newly built A1 north-south highway, located in the VI pan-European transport channel and with national railway network;



General Information

- NAUTA Shiprepair Yard was established in 1926.
- Over the 85 years NAUTA designed and built over 300 vessels, in particular special-purpose vessels, i.e. off shore vessels, tugboats, fire-fighting vessels, rescue vessels, barges, ice-breakers, dredging ships, fishing trawler etc.
- The Yard performed hundreds of complicated conversions and lengthening projects, adjusting the vessels to the requirements of both the domestic and foreign ship owners demands.
- NAUTA has also performed overhauls on thousands of vessels of different type for ship owners from all over the world

Naval Projects

- Apart from the commercial projects, the Yard also provides repair and building services Polish and foreign navies:
- In the past Nauta specialized in repair and conversions of the auxiliary and landing ships of the Soviet and Russian Navy. Hundreds of such ships visited our yard;
- In addition to shiprepairs the yard constructed over a dozen of tugs for the Polish Navy;
- Within the last three years over 20 vessels of the Polish Navy were or are being repaired at Nauta, some in close co-operation with Naval Shipyard.



New production facilities

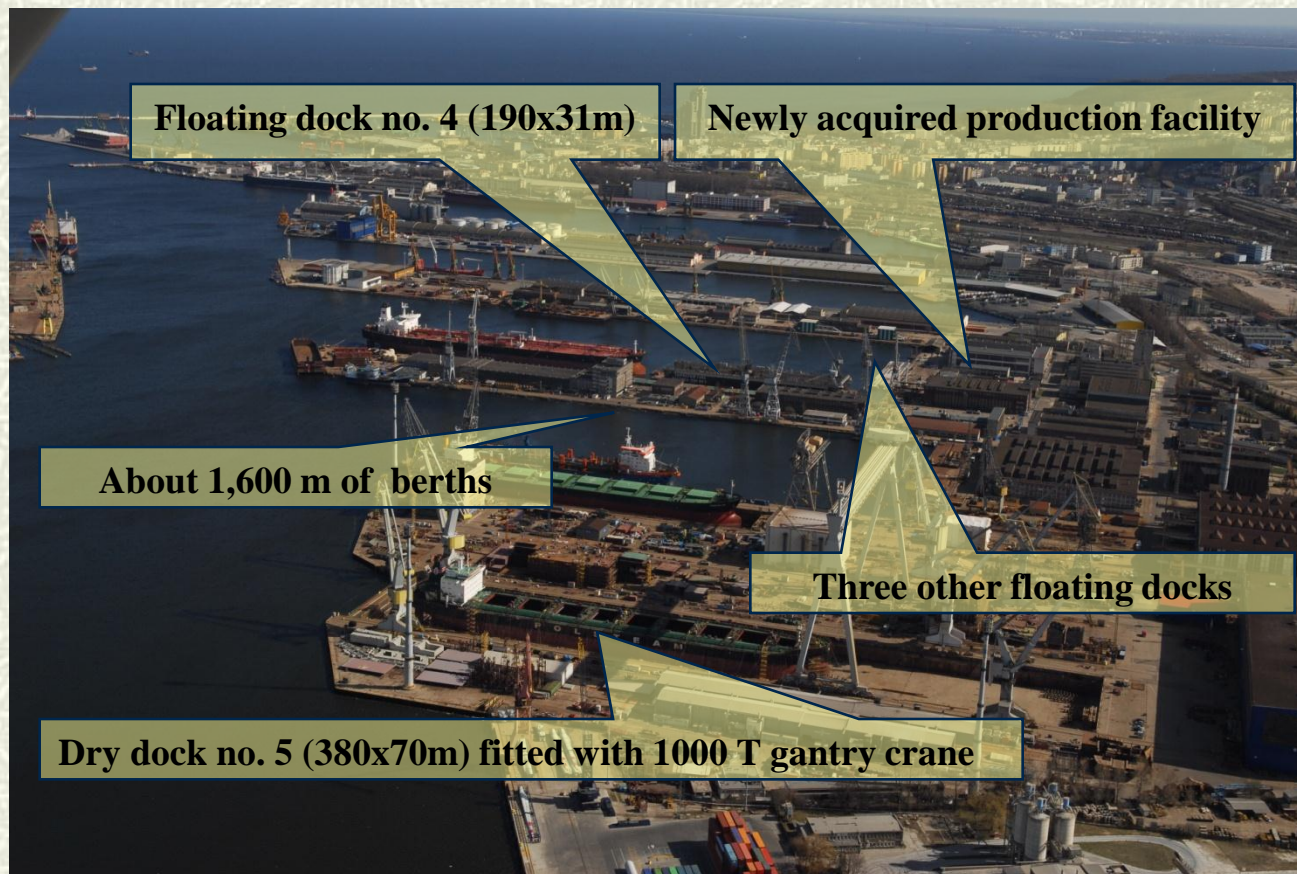

Docking Facilities

Graving Dock No.5

Length:	380.0 m
Breadth:	70.0 m
Gantry crane lifting capacity:	1,000 t
Crane lifting capacity	4 x 150 t

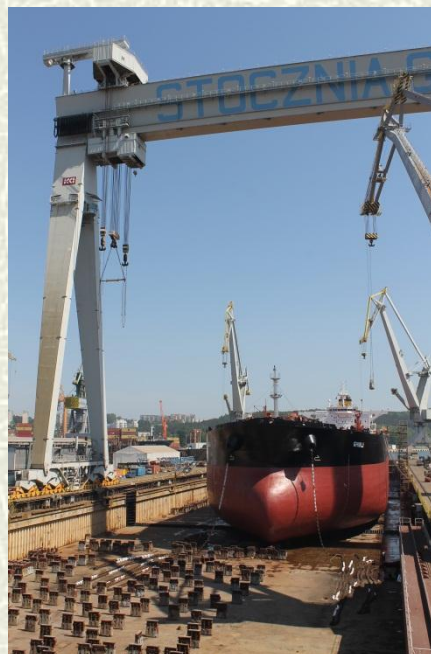

Docking Facilities

Floating Dock No.4

Length: 190.5 m

Breadth: 31.2 m

Lifting capacity: 12,000 t



Docking Facilities

Floating Dock No.3

Length:	135.0 m
Breadth:	21.0 m
Lifting capacity:	4,500 t
Crane lifting capacity	2 x 8 t

Floating Dock No.2

Length:	120.0 m
Breadth:	18.0 m
Lifting capacity:	3,500 t
Crane lifting capacity	2 x 6 t

Floating Dock No.1

Length:	76.0 m
Breadth:	13.0 m
Lifting capacity:	1,200 t
Crane lifting capacity	1 x 3 t



Our New Building Offer

Since beginning 2012 NAUTA SA has retrieved his new building program which has long history from 1931 up to 2000. Using his strong network of daughter companies each specializing in a separate section of shipbuilding as well as numerous subcontractors having long term cooperation with the Yard, NAUTA SA offers new built vessel both in turn-key and partly outfitted hull.



Our New Building Offer

According to our skills and facilities we can offer building of the following types of vessels:

- **Offshore vessels as PSV, AHTS, AHT, OSV, DSC, etc**
- **Seismic and Seismic support vessels**
- **Harbor and sea going tugs**
- **Workboats**
- **Aluminum vessels**
- **Trawlers and other fishing vessels**
- **Ferries and passenger vessels**
- **Patrol and fast boats**
- **Construction barges**
- **Dredgers**
- **Wind farm Maintenance vessels**
- **Research and training vessels**
- **Catamarans**
- **Floating cranes**



TUGS & FiFi VESSEL

Harbor Tugs

H-3000/II type

Length: 30.2 m

Breadth: 9.5 m

Number built: 1+1



Harbor Tugs

H-960 type

Length: 27.8 m

Breadth: 8.4 m

Number built: 2



TUGS & FiFi VESSEL

Harbor Tugs

H-900/II type

Length: 25.5 m

Breadth: 6.8 m

Number built: 4

Fi-Fi Vessels

SP-2700 type

Length: 37.3 m

Breadth: 9.2 m

Number built: 3



FISHING VESSELS

Research fishing vessels

BALTICA type

Length:	40.7 m
Breadth:	9.0 m
Number built:	2



Longliner Fishing trawler

THORLAKUR type

Length:	28.9 m
Breadth:	7.5 m
Number built:	1



Catamarans

Research Catamaran

Length:	40.0 m
Breadth:	12.0 m
Height:	3.50 m
Breadth:	12.0 m
Height:	3.50 m



Catamrann 12,5 m

Length:	12.5 m
Breadth:	7.6 m
Height:	1,7 m
Speed:	15-30 kn
Capacity:	120 pax



Steel construction



Aluminium construction



Interiors



NAUTA Subsidiaries

Here are some of our main daughter companies which handle new building activities:

Name	Scope of activities	Web Page
KONREM NAUTA	Steel hull and megablocks construction	www.konrem.pl
NAUTA STAL	Aluminium construction	www.nauta.pl
NAUTA-HULL	Hull repair and conversion	www.nauta.pl
DREW-NAUTA	Outfitting and interior	www.drewnauta.pl
HYDRO-NAUTA	Machinery systems and piping	www.nauta.pl
ELECTRO-NAUTA	Ship electric and electronic systems	www.electronauta.pl
TECHNO-NAUTA	Ship machinery and equipment	www.techno-nauta.pl
KORMAL-NAUTA	Painting and conservation	www.kormalnauta.pl

Certificates

Certificate of Quality System Assurance ISO 9001:200B from Polish Register of Shipping



Certificate of Quality System Assurance ISO 9001:2008 from American Bureau of Shipping Quality Evaluations

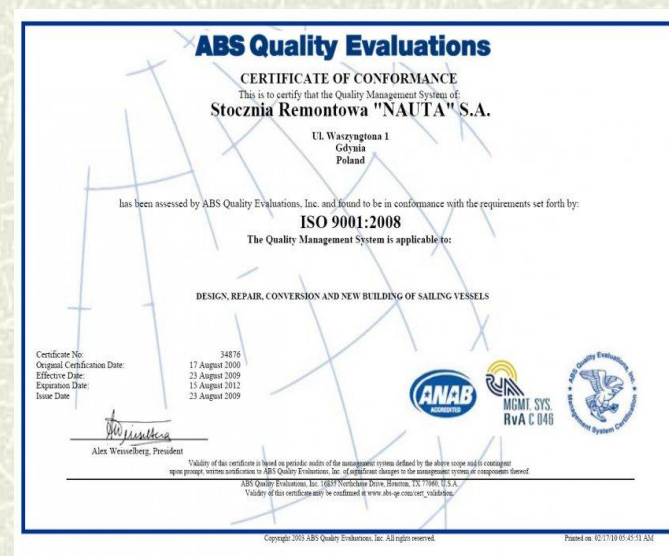

Certificates



Certificate of the NATO Commercial and Government Entity Code, **NCAGE 0256H**, issued by the Polish Bureau for Military Standardization Service



ISO 14001:2004 and 18001:2004 Certified in respect of Environmental Management System and **OHSAS**



ISPS Compliance of a Port Facility Issued for Nauta Shiprepair Yard S.A. under the provisions of Part B of the International Code for the Security of Ships and Port Facilities (ISPS Code)

Certificate of AQAP 2110:2003

NATO Quality Assurance Requirements for design, repair, conversion and new building of sailing vessels



Design and technology

NAUTA SA uses his own design office for preparation necessary drawings for building and assembly.

In addition NAUTA SA cooperates with other Polish and foreign design offices among others from Ukraine and Norway and is able to prepare a vessel design including

- Concept Design
- Technical and class documentation
- Workshop drawings
- As-build drawings

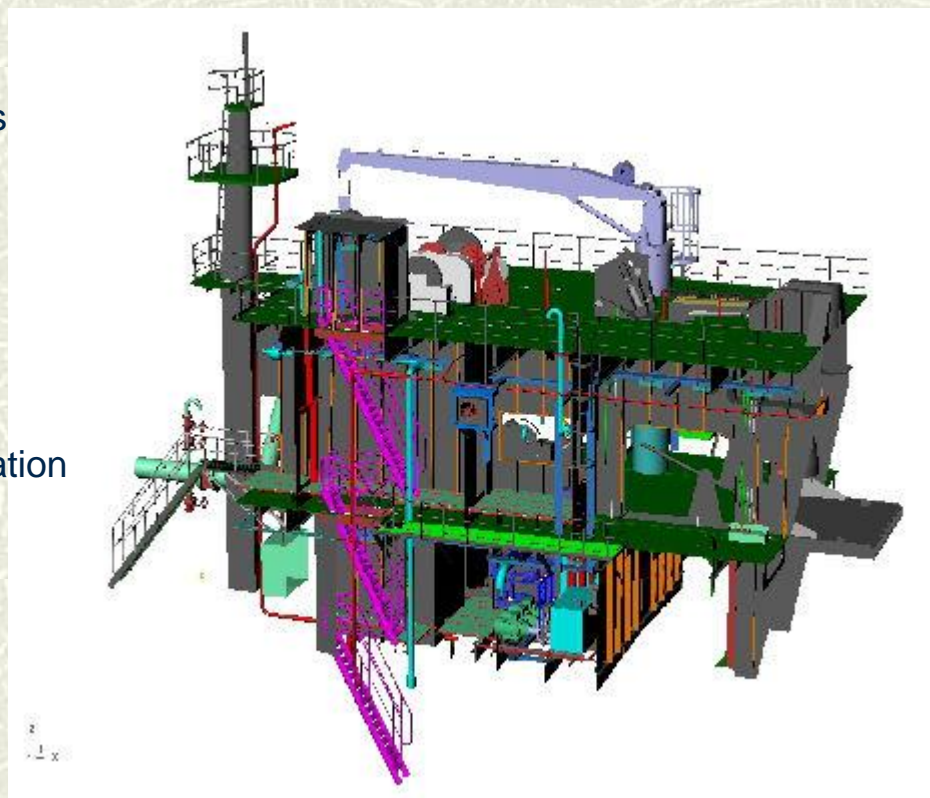

Our New Building Reference

No.	Type	Shipowner	Delivery Year	Nr of vessels	Country
1	Minesweeper	Polish Navy	1931	1	Poland
2	Cutter	Polish Maritime Institue	1931	1	Poland
3	Fishing Trawlers	Polish shipowners	1931-1935	19	Poland
4	Fishing Trawlers	Polish shipowners	1936-1937	4	Poland
5	Motor Boat	Zarząd Wodny-Kraków	1938	1	Poland
6	Dredger	Wodociągi Warszawa	1938	1	Poland
7	Rescue Boats		1939	10	Poland

Our New Building Reference

No.	Type	Shipowner	Delivery Year	Nr of vessels	Country
8	Research Vessel	MIR	1939	1	Poland
9	Fishing Trawlers	Polish shipowners	1945-1949	30	Poland
10	fishing trawlers	Polish shipowners	1946-1951	53	Poland
11	fishing trawlers B-12	Polish shipowners	1954-1955	42	Poland
12	fishing trawlers B-25	Polish shipowners	1955-1958	25	Poland

Our New Building Reference

No.	Type	Shipowner	Delivery Year	Nr of vessels	Country
13	Hydrografic vessel	GUM	1956	1	Poland
14	SAR vessel	PRO	1956	4	Poland
15	Pilot boat	GUM	1957	1	Poland
16	Traning vessel	LPŻ	1957	2	Poland
17	Barge B-300	Zarząd Portu Gdynia	1957-1963	29	Poland
18	fishing trawlers B-25s	Polish shipowners	1958-1972	52	Poland

Our New Building Reference

No.	Type	Shipowner	Delivery Year	Nr of vessels	Country
19	Ice breaker L-250	Zarząd dróg wodnych	1961	3	Poland
20	Tug H-300-II	Polish Navy	1961	2	Poland
21	Barge B-300/III	Zarząd Portu Gdynia	1961-1962	8	Poland
22	Dredger	CZWS	1964-1965	5	Poland
23	Research vessel TB-25	MIR	1967	1	Poland
24	Fire fighting vessel SP-2700	ZP gdańsk	1975-1979	3	Poland

Our New Building Reference

No.	Type	Shipowner	Delivery Year	Nr of vessels	Country
25	Dump scows 3-340		1977-1979	6	Netherlands
26	TUG H-900/II	Polish Navy	1977-1982	7	Poland
27	Floating crane 200T	ZP Szczecin	1981	1	Poland
28	VIRON-III/IV/V/VI		1985-1986	4	Netherlands
29	Ice breaker		1985	3	Poland
30	Live fish carrier		1988	1	Norway
31	Fishing trawler		1991-1996	2	Norway

Our New Building Reference

No.	Type	Shipowner	Delivery Year	Nr of vessels	Country
32	SZTORM II		1992	1	
33	Research vessel BALTICA	MIR	1993	1	Poland
34	Research vessel	Damen	1994	1	Poland
35	TUG TYTAN	WUZ-Gdańsk	1994	1	Poland
36	Seiner trawler		1996	3	Norway
37	Tug H-3000-II / HEROS	WUŻ Port Gdynia	1999	1	Poland
38	Longliner THORLAKUR	GO-DP	2000	1	Iceland

Contact

NAUTA SHIPREPAIR YARD

Waszyngtona St. 1, 81-342 Gdynia, Poland

E-mail: poczta@nauta.pl

www.nauta.pl

Commercial Departament (new building)

E-mail: e.jagielska@nauta.pl

phone +48 58 621 2561

Fax: +48 58 620 36 37

